

Cantiere delle Marche S.r.l.
Via E. Mattei, 36 - 60125 Ancona - Italy

www.cantiereellemarche.it
info@cantiereellemarche.it - T. 071 206705

M/Y Babbo one off 43 m



CANTIERE
DELLE MARCHE
explorer's attitude

BABBO

M/Y Babbo: A family's vision for a pure custom explorer yacht



*Babbo is robust, reliable,
and effortlessly elegant,
embodying the very essence
of understated sophistication.
She does not seek to
impress with ostentation or
flamboyance: her ingrained
quality in construction and
design speaks for itself.*

We chose to present *Babbo* simply and directly, through the impressions and experiences of those who turned this project into the remarkable explorer yacht it has become: Owners, designers, the shipyard. Bold and elegant, this explorer yacht has travelled thousands of miles since her delivery on September 2024, fulfilling her Owners' expectations and rewarding them with a profound sense of satisfaction and pride.

To help you better understand the characteristics of this imposing explorer yacht, we will first share a few key figures and data before giving voice to the main players and their perspectives:

Babbo has a **total length shy of 43 metres**, a length at **water level of 39.30 metres**, and a **max beam of 8.67 metres**, she has **three decks (plus a Sun deck)** one of which – the Main deck – has a **wide body configuration from midship forward**. Her **Gross tonnage is 476GT**.

These initial data are pivotal in conveying the yacht's proportions – essentially, her overall body configuration. The resulting image is that of an imposing yacht with generous volumes that accommodate equally spacious interiors. **Designer Francesco Paszkowski** conceived an aesthetic that fuses architectural rigour with softness, creating a yacht that embodies both structural strength and elegance.

She accommodates **twelve guests across six suites**: four located on the main deck and two twin cabins on the lower deck. There is no dedicated owner's suite, as the yacht belongs to three brothers and the distribution of spaces reflects their egalitarian approach, with no hierarchical prioritisation.



Babbo's general plans

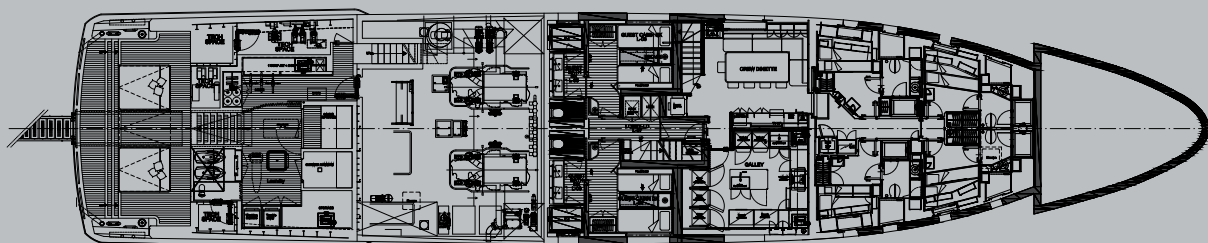

Lower deck

From stern to bow: A large lazarette with adjoining technical spaces serves as a versatile area combining both recreational and functional features. It accommodates diving equipment, bicycles, water toys, and laundry facilities. The sauna and hammam open directly onto the lazarette, which also provides access to the spacious, well-appointed engine room. Entry to the lazarette is via a staircase from the main deck cockpit or directly from the swim platform through a large hatch. From amidships forward, two twin guest cabins are located amidship, followed by comfortable crew quarters, which comprise four cabins, a spacious galley, and a generous crew mess.

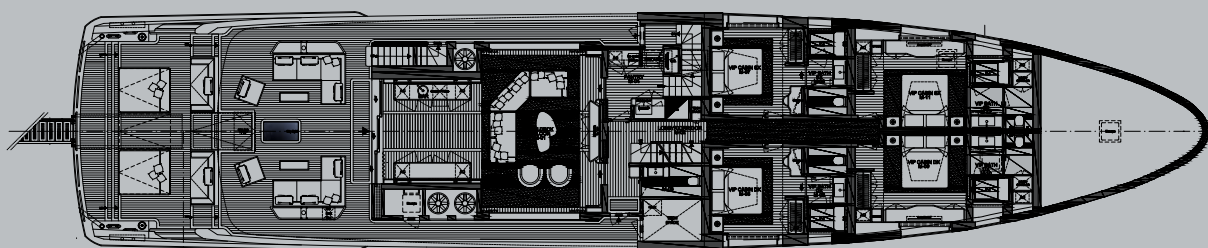

Main deck

A relatively small superstructure houses a cozy lounge that opens onto an expansive deck area, seamlessly connecting the indoor spaces with the sea. A full beam staircase, furnished with sofas and sunbeds, gently slopes down to the swim platform, creating an exceptionally inviting and enjoyable area. From amidship forward, the yacht has a wide body configuration giving space to four almost identical Owners' suite.

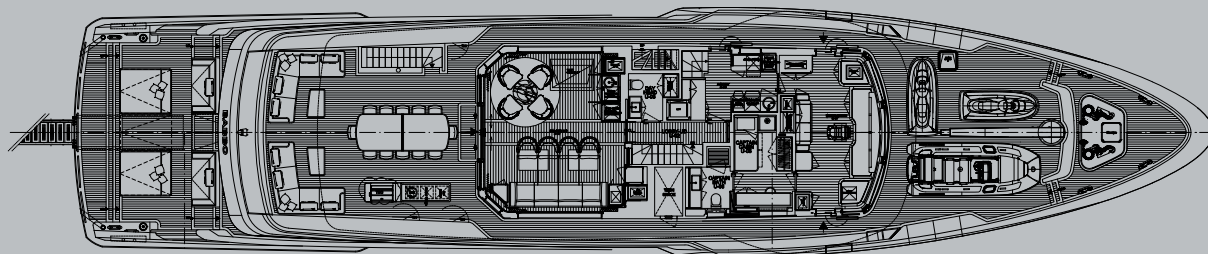

Upper deck

This deck is primarily dedicated to dining, featuring an indoor, panoramic dining area and a large outdoor table sheltered by the Sun Deck overhang. For efficient service, a well-equipped pantry is provided. The Captain's cabin opens directly onto the wheelhouse. Forward, two tenders are stored and can be easily launched using a powerful crane.

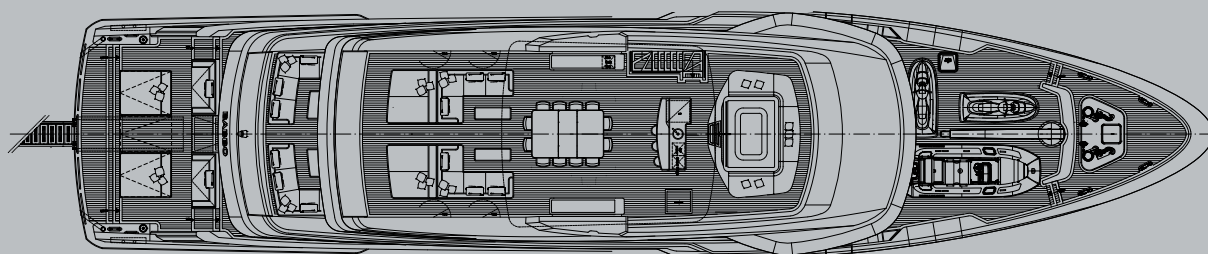

Sun deck

The spacious and partially shaded Sun Deck offers a full range of amenities for relaxing at anchor or underway, including a dining area, bar, sunbeds, and a panoramic swimming pool.

The Owners' point of view



“

Our new explorer yacht is a fully bespoke creation that builds upon everything we loved about our previous vessel, the Darwin 102. We spent years enjoying life aboard the previous *Babbo*, appreciating its thoughtful design, dependable performance, and all the moments it allowed us to share as a family. Over time, as our family expanded and our needs evolved, we realised we required a larger yacht to offer everyone greater comfort and space.

Just like our former yacht, this new *Babbo* is conceived as *a true family home on the water*, a place where we can all come together or find peaceful moments alone, depending on each person's plans. We wanted her to feel like a natural extension of our lifestyle: *comfortable, functional, and quietly elegant without ever being ostentatious*.

Our strong relationship with *Vasco Buonpensiere* and the entire CDM team gave us the confidence to progress from a semi-custom build to a fully custom project. This approach ensured we could craft an explorer yacht that reflects exactly what we envisioned, with the ideal balance of indoor and outdoor spaces to suit our way of living and cruising. We shared our aspirations for style and usability, and the proposal presented by CdM and *Francesco Paszkowski* captured our vision perfectly.



As a family, we have never been inclined towards showiness, so we all agreed that the interiors should embody refined elegance while remaining understated and welcoming. We wanted a space that felt sophisticated and timeless, one we could enjoy privately without feeling flashy or overdone.



The cockpit opens onto an expansive staircase that transforms into a sea-facing lounge area just steps from the sea.

To achieve this, we entrusted **Francesco Paszkowski** with the **interior design**, too, confident in his ability to create an aesthetic that harmonises seamlessly with the yacht's exterior lines. His expertise was instrumental in realising our goals, crafting interiors that are both beautiful and highly functional for family life on board. We asked him to develop a layout that truly reflected how we spend time on our yacht, including **four identical suites** so every family member could enjoy the same level of comfort and luxury.



Four almost identical suites offer the same level of comfort to the Owners on the Main deck forward.



Creating generous social areas was another priority for us. *We wanted ample, relaxed spaces* to gather, share meals, and spend quality time together, so the yacht offers expansive living areas across the Main and Upper decks.

Equally important were the *extensive outdoor spaces* designed to make the most of the sea and scenery around us, enhancing the experience for everyone who comes aboard.

”





Francesco Paszkowski about the project, from inception to completion



“

We approached the project with a well-defined vision, made possible by the exceptional collaboration between CdM, the Owners, and our studio. Their trust in us to create a yacht that seamlessly blends contemporary elegance with timeless appeal allowed us to deliver a vessel that perfectly embodies the best of both explorer yachts and luxury yachts. This unique balance ensures that the yacht is equally suited for adventurous exploration and sophisticated leisure.

Based on the initial renderings, a few modifications were made to align precisely with the Owners' vision while further refining Babbo's overall design.





Babbo's key design features:

- Elegant and awe-inspiring exterior design.

Babbo's exterior lines are designed to be striking and memorable, combining beauty with purpose. Her bold stance, especially with the imposing bow, ensures she stands out everywhere she goes. Her **muscular yet elegant profile** is accentuated by expansive side windows that span the **widebody section of the superstructure**, offering panoramic views and enhancing the dynamism of her silhouette. These **windows mark an evolution from the original design**, as both we and the Owners agreed that a unique, elongated window creates a softer profile compared to vertical windows, which would impart a more aggressive appearance. The elegantly designed overhangs of her decks add a sense of refinement, blending strength with sophistication in perfect harmony.

- Grand exterior deck spaces:

The deck layout is thoughtfully designed, providing ample outdoor spaces where guests can relax in privacy. These areas are seamlessly integrated to offer a sense of openness and flow throughout the yacht. **The stern area has been redesigned creating a multi-level beach area**, with sun beds and sofas, that leads from a large cockpit to the swim platform.





- Uninterrupted living spaces:

The architecture of Babbo focuses on making outdoor and indoor spaces feel continuous, offering a seamless transition between them.

- Privacy and Openness:

The exterior spaces are not only designed for relaxation but are also positioned to provide maximum privacy while still feeling open and free, ideal for enjoying various outdoor settings onboard.



- Crew areas and circulation on board:

The yacht accommodates **a crew of nine** in comfortable, well-appointed quarters. On the Lower Deck, there are four cabins for eight crew members, along with **a spacious dinette that has direct access to the galley**. The Captain's cabin is located next to the Wheelhouse on the Upper Deck.



A key priority for us was ensuring **efficient service and circulation** throughout the yacht, which is why there are pantries on every deck and **dedicated staircases** for the crew. When underway, the lazarette and engine room are easily accessed via a staircase from the Main Deck cockpit. When at anchor, there is direct access through a large stern hatch that connects the generous swim platform to the wellness area (sauna and hamman) located on the aft lower deck.

”





*What makes Babbo
a true explorer yacht:*
Hydro Tec on the yacht's
naval architecture



“

As the naval architects responsible for the design of this 43-meter yacht, our focus has been to create a vessel that combines exceptional efficiency with outstanding seakeeping capabilities. The **hull design features a refined and optimized shape**, aimed at **reducing drag and improving fuel efficiency**. This allows the yacht to achieve impressive performance and range, even with a modest propulsion system.

The yacht's hull form is specifically designed to ensure excellent hydrodynamic efficiency, minimizing resistance through the water. This not only enhances fuel economy but also extends the vessel's range, allowing for long-distance cruising with fewer fuel stops. **The combination of an efficient hull and carefully selected engines results in a yacht that is both environmentally conscious and operationally cost-effective.**

In terms of seakeeping, the hull is designed to perform admirably in a wide range of sea conditions. Whether cruising at high speeds or navigating through rough waters, the yacht maintains stability, comfort, and safety for all on board. The balance between hydrodynamic efficiency and stability ensures smooth operations, reducing the impact of wave motion and improving overall onboard comfort.

We optimized the internal structure by adjusting the spacing between supports to 50 cm and reducing their dimensions. This allowed us to maintain ample space for accommodations while preserving the vessel's strength and durability.

This yacht represents a perfect blend of engineering and design, offering owners a vessel that is both sustainable and capable, with the autonomy to embark on extended voyages without sacrificing performance or comfort.

”



Babbo in the words of her builder



“

At our shipyard, the construction of an explorer yacht goes beyond just building a vessel: it's about crafting a vessel that combines beauty, robustness, and technical excellence. Our approach begins with a commitment to designing a yacht that is not only aesthetically stunning but also highly functional and dependable in even the most demanding maritime conditions.

Robust construction: Durability is at the core of our construction process and Babbo is no exception. We used the highest-grade materials, steel and aluminium, from the hull (8mm thick plates) to the superstructure, ensuring that the yacht is built to withstand the harshest ocean environments.

The structural integrity of the vessel is designed with a focus on longevity, stability, and strength. Our expert craftsmen and engineers work closely together to build a yacht that can venture safely into remote, challenging waters, ensuring a smooth and secure journey, whether crossing vast oceans or exploring secluded bays. Lowering noise and vibration transmission is mandatory and our construction systems with thick layers of insulating materials and rubber mounted engines and generators basements, bulkheads, and ceiling structural supports do the job as witnessed by the noise and vibrations levels report: just two figures to give an idea of the excellent performances: 38.6db(A) in the salon at anchor, 33.4 db8A) in the cabins on the Main deck.



Technical equipment and reliability: In the heart of an explorer yacht lies its technical systems, which must perform flawlessly to ensure safe and comfortable voyages. We equipped Babbo with state-of-the-art navigation, communication, and propulsion systems, all sourced from industry-leading manufacturers known for their reliability. **Two pairs of CMC Marine electric stabilizers** with large fins grant stability both underway and at anchor; every piece of equipment is rigorously tested to meet the highest standards, and redundancy is built into essential systems to minimize the risk of failure. The yacht's mechanical and electrical systems are designed for long-term dependability, allowing for extensive cruising without constant need for maintenance or repair.

Beyond individual systems, we ensure that every aspect of the yacht, from its engines to its environmental control systems, is seamlessly integrated.



This creates an intuitive operational experience for both the crew and the Owners, enabling ease of use, enhanced safety, and energy efficiency.

The decision to install modestly powered **engines (2 x Caterpillar C32 Acert 746 kW) with a selective catalytic reduction (SCR)** system reflects a focus on fuel efficiency, emission reduction, and long-range capability. These engines, despite their moderate power output, are paired with very generous fuel tanks (**over 60,000 liters**), which allow for an impressive autonomy of over 5,000 nautical miles at a cruising speed of 10 knots. The SCR system helps ensure compliance with stringent environmental regulations by **reducing harmful nitrogen oxide (NOx) emissions**, making the vessel as environmentally friendly as possible."

”



A close look at *Babbo's interiors*



Wooden strips:
how a recurring theme creates a perfect
balance between surfaces and volumes,
enhancing both.

Babbo's interiors signature style is characterized by an **understated sophistication**, enveloped in a delicate palette that transitions seamlessly from **warm whites to earthy, sandy tones**. These hues create an atmosphere of **profound calm**, reminiscent of Mediterranean limestone cliffs at golden hour. As you step inside, the first impression is of **vastness and light**.



A super-comfortable
Flexform Harper sofa by
Antonio Citterio with saddle-
hide-clad console armrest
lends a distinctive good look.

Walls panelling, ceilings, and cabinetry are adorned with *wooden strips*, their fine linear rhythm creating a *play of chiaroscuro*. The gentle shadows cast between each strip change dynamically throughout the day as natural light filters in from panoramic glazing, adding *depth and a sense of movement* to the otherwise serene, minimalistic backdrop.

This **wood strips** continue seamlessly along feature walls, integrating storage elements with silent push-latch systems, maintaining absolute **cleanliness and linear purity**. The wood itself is a pale, warm oak with delicate veining, treated with a matte oil to preserve its authentic texture while blending harmoniously with creamy woven fabrics and warm sand-tone, tan or taupe leathers.

The flooring is an **ultra-matte engineered European oak (tatami finishing)** in wide planks, while low furnishings 'float' almost sculpturally on the floor.



On the Upper deck, a more angular sofa by Maxalto creates a panoramic, lounging area in the Skylounge that is conceived as an indoor dining area. The Maxalto Pathos table with Calacatta marble top is surrounded by low Maxalto Febo chairs.



Lighting is both hidden and intentional. Cove lights wash gently upwards behind the slatted wood features, amplifying the chiaroscuro effect without glare. Recessed micro spotlights punctuate the ceiling sparingly, and integrated reading lights emerge seamlessly from behind panels and headboards. The entire effect is of light *emanating from within the architecture itself*, never imposed.



On the walls of the staircases, the wooden strips are replaced by lattices reminiscent of a Japanese interior.

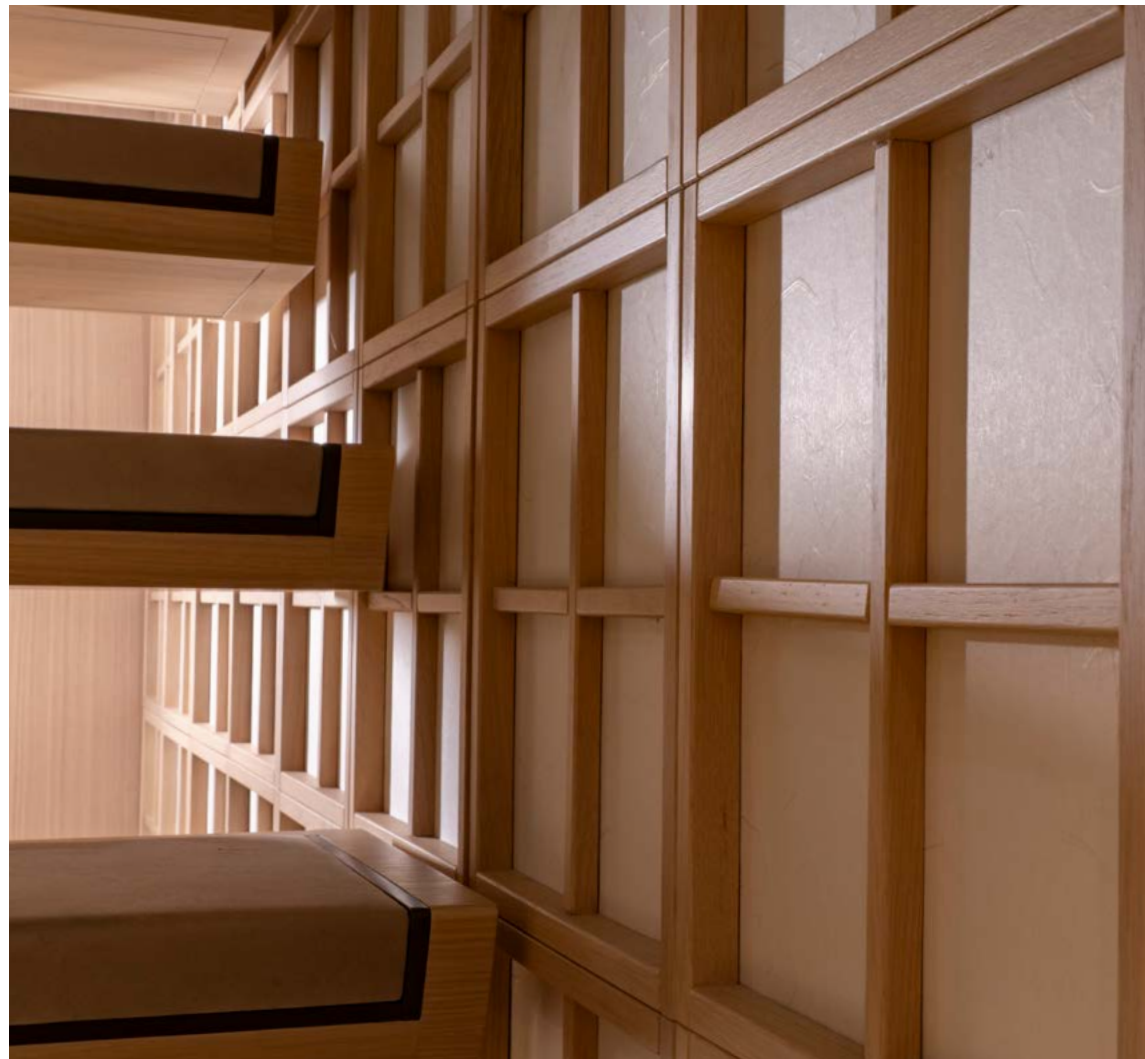

In the salon, walls and some of the cabinets feature vertical strips, their grain direction carefully matched for visual continuity with part of the ceilings. Coffee tables combine pale Calacatta tops with matte dark bronze structures, introducing subtle mineral accents without overpowering the neutral envelope.



Moving into the owners' suites, the design becomes even more **reductive yet intimate**. Part of the headboard walls are clad in vertical wooden strip panels, forming a sculptural yet tranquil backdrop for the bed. Flanking nightstands appear as cantilevered extensions of the panelling, emphasising the concept of **furniture as pieces of architecture**.





Throughout the yacht, there is an overwhelming sense of **complex simplicity**: details are highly refined, hidden, and resolved with obsessive precision to maintain the purity of form. Ventilation grilles are seamlessly integrated, and blinds are nicely concealed within ceiling coffers.

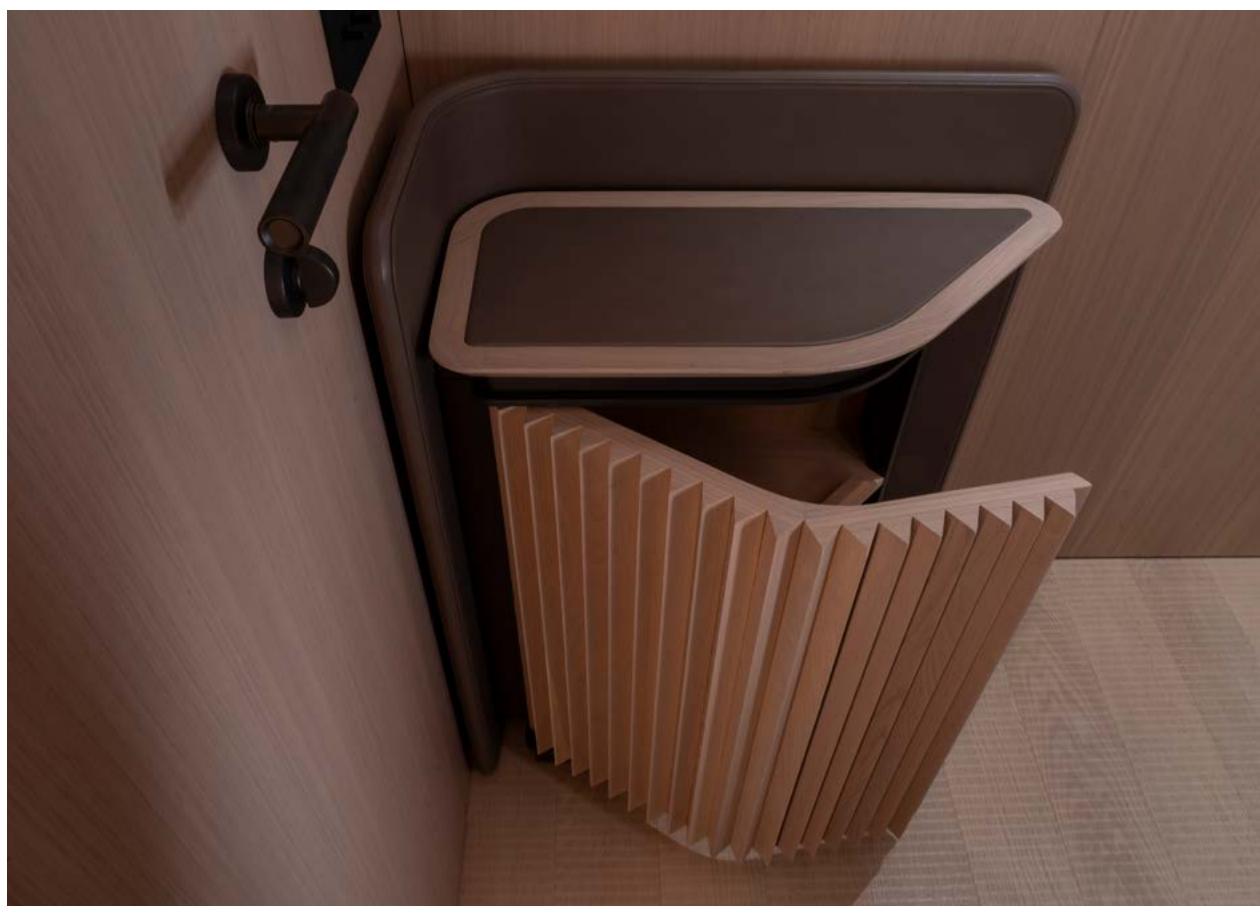

In this yacht's interiors, *the complexity lies in its perfect linearity and absence of visual noise*. The wood strips chiaroscuro adds character and life to the serene palette, ensuring that while the environment feels peaceful, it is never monotonous. Instead, it is *rich with subtle texture, rhythmic shadows, and quiet sophistication*, embodying *discreet luxury and architectural restraint*.

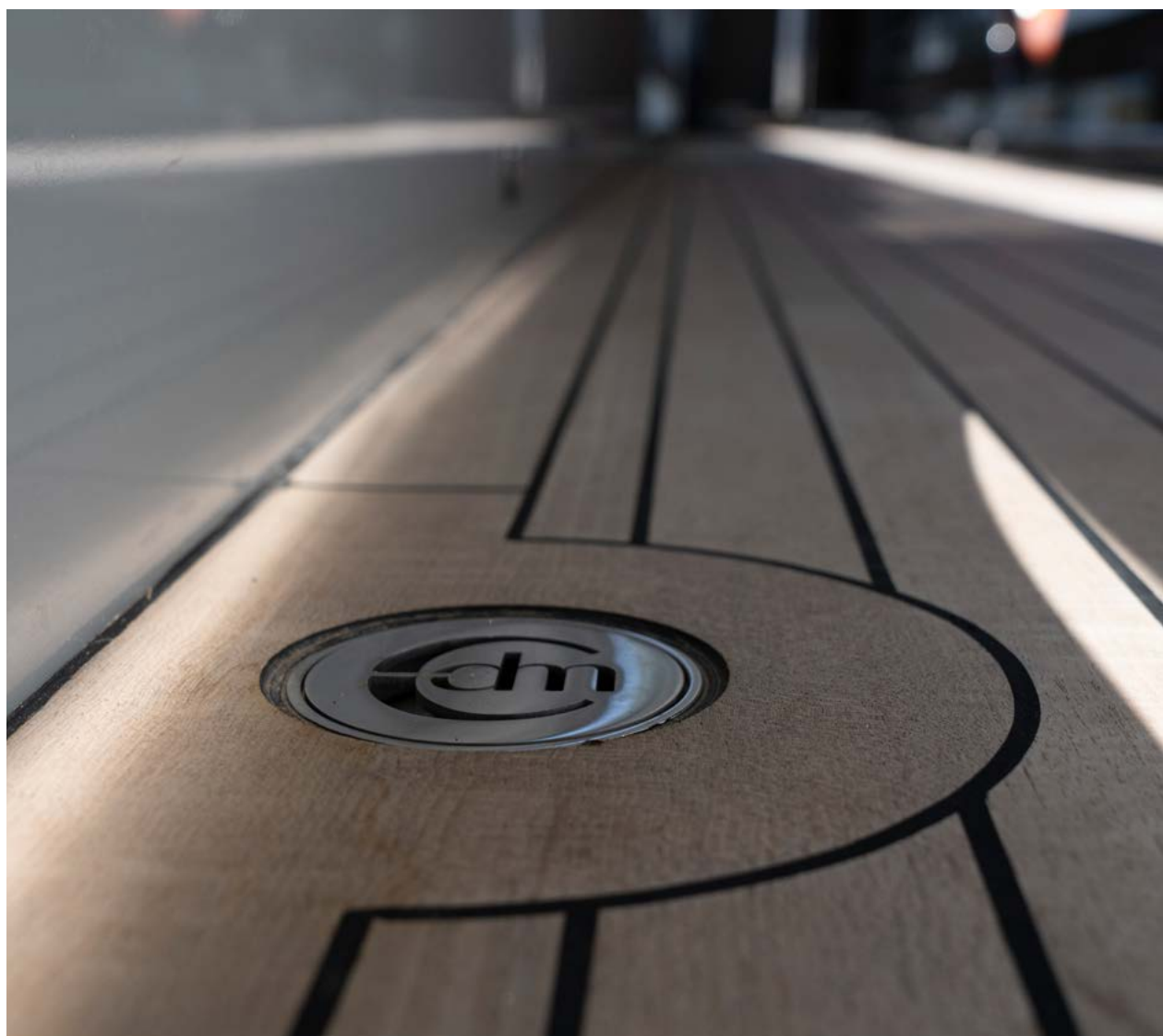



CANTIERE
DELLE MARCHE
explorer's attitude